

DIMENSIONS

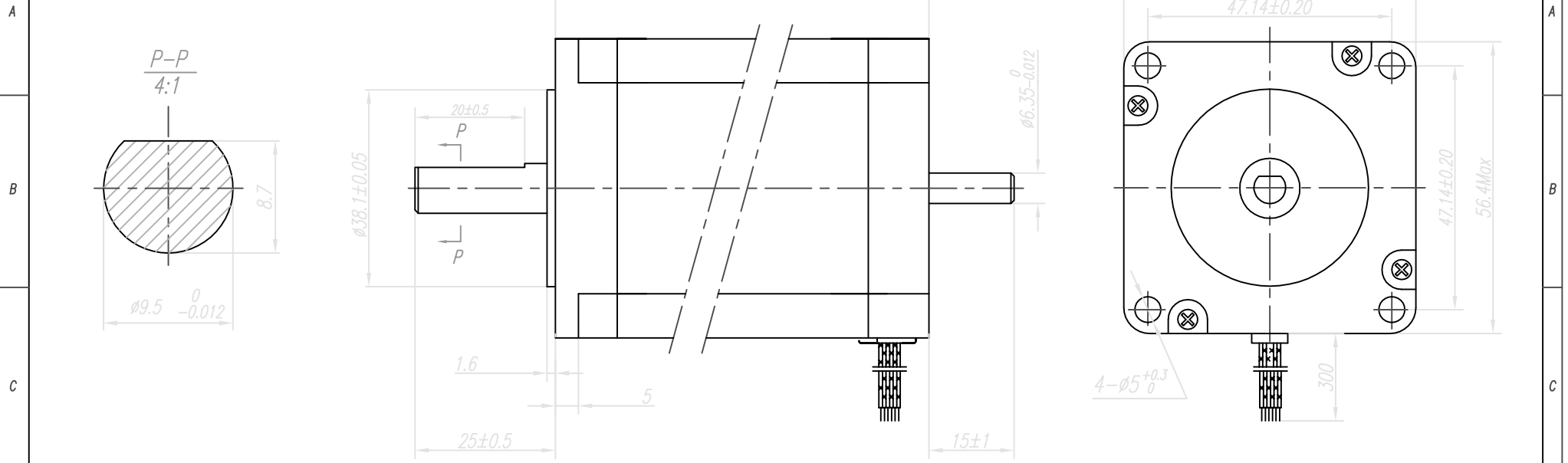

SPECIFICATIONS unit=mm

PHASE	2	PHASE	
STEP ANGLE	1.8±5%	°/STEP	
DETENT TORQUE	12	N.cm Max	
INSULATION CLASS	B		
LEAD STYLE	AWG22 UL1007		
	UNIPOLAR RESP.ONE WINDING	BIPOLAR RESP.BIPOLAR SERIAL	BIPOLAR ONLY PARALLEL
CURRENT	2.12 A/PHASE	1.5 A/PHASE	3.0 A/PHASE
RESISTANCE	3.2 ±10% Ω/PHASE	6.4 ±10% Ω/PHASE	1.6 ±10% Ω/PHASE
INDUCTANCE	6.8 ±20% mH/PHASE	27.2±20% mH/PHASE	6.8 ±20% mH/PHASE
HOLDING TOGQUE	200 N.cm Min	280 N.cm Min	280 N.cm Min

COLORS OF LEAD WIRES BIPOLAR & UNI-POLAR

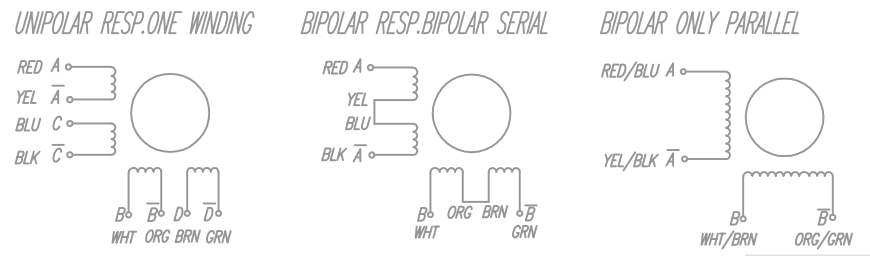

DATE 20070111  
EDIT B



www.machinet.com.ar

REV	QTY.	NO.	SIG.	DT.
DESIGN		20070111	CHECK	
PROC.			APPR.	

CLS.MAK	WEIGHE	SCALE	23HS2821-05
EDIT.	PAGE	OF PAGES	